



stalgast
ekspert gastronomiczny

Instruction Manual

v1.0 - 04.2015

ELECTRIC JUICER

MODEL: 480021



Stalgast sp. z o.o. ul. Staniewicka 5 03-310 Warszawa
tel.: 22 517 15 75 fax: 22 517 15 77 www.stalgast.com email: stalgast@stalgast.com





1. SAFETY INSTRUCTIONS	3
2. TECHNICAL SPECIFICATION	3
3. STRUCTURE OF THE DEVICE	4
4. SETTING UP THE DEVICE	4
4.1. Connecting power supply	4
4.2. Placement of the device	4
5. OPERATING THE DEVICE	4
6. CLEANING AND MAINTENANCE	4
7. END-OF-SERVICE LIFE RECYCLING	5
8. WARRANTY.....	5





Thank you for your purchase of a Stalgast product. Before use please familiarize yourself in detail with the following instruction manual.

Copying of the following manual without the consent of the manufacturer is prohibited.

Images and drawings are of illustrative character and may differ from the purchased product.

ATTENTION: This manual should be kept in a safe place accessible for personnel. The manufacturer reserves the right to change the technical characteristics of the product without any notice.

I. SAFETY INSTRUCTIONS

- Attention! If this device was damaged in transport it should not be connected to electricity!
- Incorrect maintenance and/or use may cause serious harm to people and damage the device.
- The device can only be used for the purpose for which it has been designed.
- The manufacturer does not take any responsibility for damages caused by improper maintenance or use of the device.
- When in use, secure the device and its electrical plug from any contact with water or other fluids. In case the device is accidentally dropped into water the electrical plug should be immediately removed from the socket and the device should be inspected by a trained professional.

Failure to obey these instructions may cause life-threatening danger.

- Never open the casing of the device on your own.
- Do not stick any objects into the casing of the device.
- Do not touch the electrical cord plug with wet hands.
- Check the condition of the electrical plug and cord regularly. In case any damage to the plug or cord is discovered order repair by a specialized service provider.
- In case the device is dropped or damaged otherwise, before further use always order a check-up and repair by a specialized service provider.
- Do not make any attempts to repair the device on your own – this may cause life-threatening danger.
- Any attempts to modify or repair the device by unauthorized, untrained staff are prohibited.
- Protect the electrical cord from contact with sharp or hot objects and keep it away from open fire. When you disconnect the device from the electrical socket always hold the plug and never pull the electrical cord.
- Secure the electrical cord (or the extension cord), so that it is not unplugged by mistake and so that no one can stumble over it.
- If the electrical cord is damaged it should be replaced. The integrated power cord may be replaced at specialized service centers or by a qualified electrician.
- Monitor functioning of the device while in use.
- Use of the device by people underage, physically or mentally incapable, with motion disorders as well as people without proper experience and knowledge regarding the use of this device should not be allowed. All of the above should only use the device under supervision of a person responsible for their health and safety.
- When not used or during maintenance you should always unplug the device from the source of electricity by removing the electrical plug from the socket.
- ATTENTION: when the electrical plug is plugged into the socket the device is constantly live.
- Switch the device off before removing the plug from the socket.
- Never pull the device by the electrical cord.
- Housing of this device may become hot. Be careful not to burn yourself while using it.

2. TECHNICAL SPECIFICATION

Power supply	230V@50Hz
Total generated power	180 W
Dimensions Øxh	212x287x396mm





3. STRUCTURE OF THE DEVICE

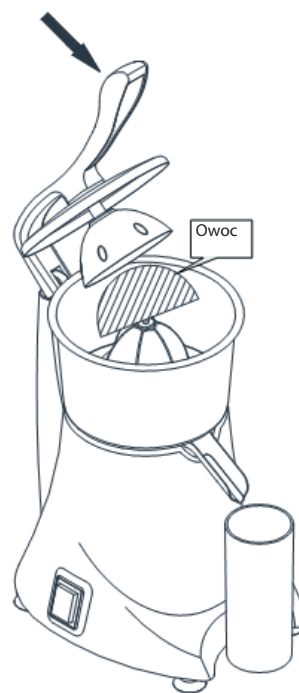
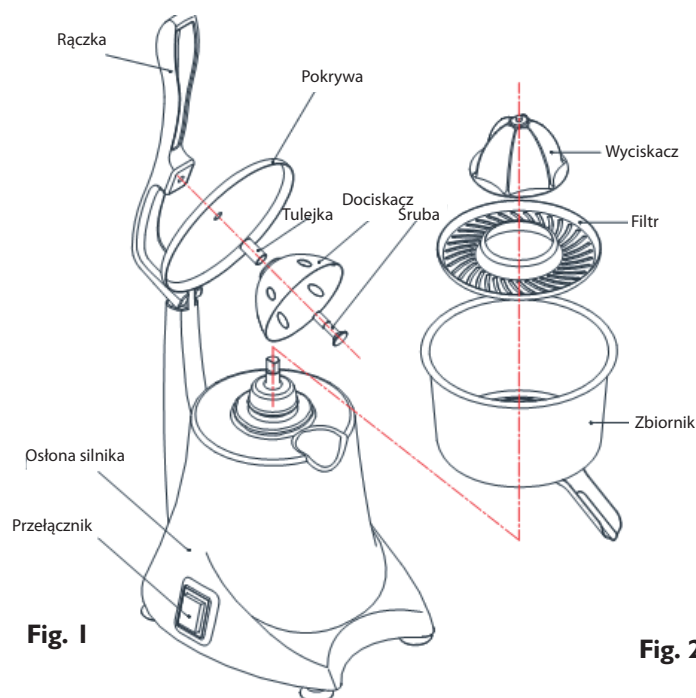

Fig. 1

Handle (rączka)

Lid (pokrywa)

Bushing (tuleja)

Pusher (dociskacz)

Screw (śruba)

engine housing (osłona silnika)

switch (przełącznik)

juicer cone (wyciskacz)

filter (filtr)

container (zbiornik)

Fig. 2

Fruit (owoc)

4. SETTING UP THE DEVICE

4.1. Connecting power supply

This device should be connected to a source of electricity using the supplied plug. The socket should be grounded and equipped with a residual current device.

4.2. Placement of the device

The device should be set up on an even, stable surface.

5. OPERATING THE DEVICE

1. Set the juicer cone in the right place,
2. Place the a container for juice on the drain,
3. Cut the fruit in half,
4. Switch the device on by turning the on-off switch to I,
5. Press the fruit on the juicer cone to obtain juice,
6. Switch the device off when finished.

6. CLEANING AND MAINTENANCE

a. Before cleaning the device:

- Set the power switch to "0"
- Disconnect the device from electricity

The device should be cleaned after each use. Elements of the device should be cleaned regardless of whether they were in contact with the fruit or juice, or they remained unused.

It is now allowed for the device to be cleaned with running water or in an industrial washer. It is also not allowed to use brushes or other cleaning tools which may damage surface of the device. To wash this device use water and a neutral detergent.

b. Cleaning of the bowl, the juicer cone and the juice container

In order to clean the bowl and the juicer cone take both the elements off the device carefully. After removing from the device wash the elements with hot water and some neutral detergent. After washing the parts rinse and dry them carefully.





c. Cleaning the housing

Before cleaning the housing of this device disconnect it from the source of electricity.

In order to clean the housing of the device use a neutral detergent and a damp cloth, remember to

7. END-OF-SERVICE LIFE RECYCLING

After the device reached its end-of-service life or when buying new equipment at Stalgast you can return the old device. Send it to us and a specialized company will recycle it in accordance with the ESOL for Electrical and Electronic Equipment Act (Legal Journal 2005 no. 180 point 1495).

8. WARRANTY

The seller provides warranty for the product.

Any damage resulting from settlement of calcium on the device is not covered by the warranty.

The warranty also does not cover: damages resulting from external causes such as lightning, change in voltage, improper setup of the electricity supply, connecting to an improper source of electricity, mechanical, thermal or chemical damages.

Such elements as light bulbs, rubber elements, heating elements damaged by limescale, screws and elements which naturally wear down such as heaters, gaskets, and any other elements damaged mechanically are not covered by the warranty.

