

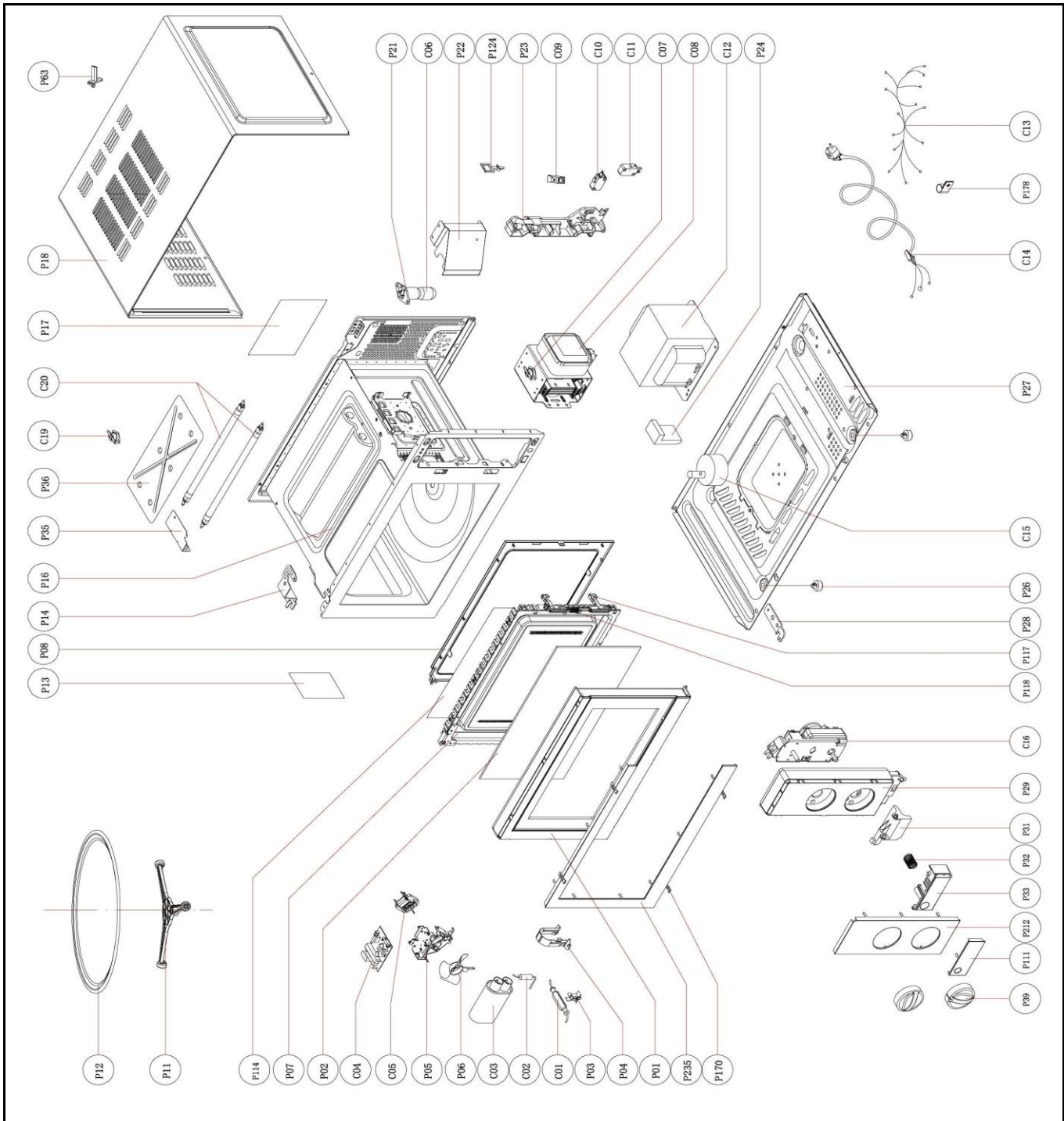

# Drawing

 <p><b>Hendi B.V.</b>                  Steenoven 21                  3911 TX Rhenen                  The Netherlands</p>	<b>Batch #</b>	<b>Appliance part#</b>
	0000000	281703
	<b>Description</b>	
	Microwave	

<b>Date</b>	26-04-2012	<b>Revision #</b>	Revision version
<b>Revision</b>	First bill of materials (BOM)		



### Bill of materials (BOM)

 <b>Hendi B.V.</b> Steenoven 21 3911 TX Rhenen The Netherlands	<b>Batch #</b>	<b>Appliance part#</b>
	0000000	281703
	<b>Description</b>	
	Microwave	

<b>Date</b>	26-04-2012	<b>Revision #</b>	Revision version
<b>Revision</b>	First bill of materials (BOM)		

Item	Description	Part#	Quantity	Remark	Picture
P01	Door complete.	921449	1		
P02	Door window	nss	1	Available in set 921449	
P03	Fuse socket	n/a	1		
P04	Capacitor holder	n/a	1		
P05	Fan bracket	n/a	1		
P06	Fan blade	n/a	1		
P07	Door frame	nss	1	Available in set 921449	
P08	Cover door	nss	1	Available in set 921449	
P11	Roller ring	921302	1		
P12	Glass tray	921319	1		
P13	Mica plate	928387	1		
P14	Upper hinge	n/a	1		
P16	Housing	n/a	1		
P17	Label	n/a	1		
P18	Outer cover	n/a	1		
P21	Lamp socket	904961	1		
P22	Air duct bracket	n/a	1		
P23	Microswitch mounting	921432	1	(Set incl. C9,C10,C11)	
P24	Rubber block	n/a	1		
P26	Foot	900390	4		
P27	Bottom plate	n/a	1		
P28	Lower hinge	n/a	1		
P29	Dashboard frame	n/a	1		
P31	Lever	921326	1		
P32	Button spring	nss	1	Available in set 921326	
P33	Button	n/a	1		
P35	Tube holder	n/a	1		
P36	Heat shield	n/a	1		
P39	Knob	921333	2		
P41	Metal rack	921463	1		
P63	Buckle	n/a	1		
P111	Button cover	n/a	1		
P114	Sheet	nss	1	Available in set 921449	
P117	Door hook	921340	1	Also available in 921499	
P118	Spring door hook	900512	1	Available in set 921449	
P124	Clamp	n/a	1		
P170	Clip (glass)	nss	1	Available in set 921449	
P178	Clip	n/a	1		
P212	Dashboard cover	n/a	1		
P235	Door cover	nss	1	Available in set 921449	
C01	H.V.fuse (5KV-0,7A)	921470	1		
C02	H.V. diode	921357	1		
C03	H.V. capacitor	921364	1		
C04	Filter print	921371	1		
C05	Fan motor	900444	1		
C06	Lamp	900468	1		
C07	Thermostat	n/a	1		
C08	Magnetron	921388	1		
C09	Microswitch	nss	1	Available in set 921432	
C10	Microswitch	nss	1	Available in set 921432	
C11	Microswitch	nss	1	Available in set 921432	
C12	Transformer	921395	1		
C13	Wiring harness	n/a	1		
C14	Power cord	921456	1		

C15	Turntable motor	921401	1		
C16	Timer	921418	1		
C19	Thermostat	n/a	1		
C20	Quartz tube	921425	2		

n/a -> not available

nss -> not sold separately

### Circuit diagram

 <p><b>Hendi B.V.</b> Steenoven 21 3911 TX Rhenen The Netherlands</p>	<b>Batch #</b>	<b>Appliance part#</b>
	0000000	281703
	<b>Description</b>	
	Microwave	

<b>Date</b>	26-04-2012	<b>Revision #</b>	Revision version
<b>Revision</b>	First bill of materials (BOM)		

